



Schiedel Gas Flue Block System

The Schiedel Gas Flue Block System provides the ideal solution to build a safe and high performance flue for gas appliances.

Schiedel Gas Flue Block System

Introduction

The Schiedel Gas Flue Block System is a high quality factory made gas flue block system which provides the ideal solution to build a safe and high performance flue for gas appliances.

The standard blocks have a height to match brick or blockwork and can be built into traditional cavity wall construction, which saves on cost and space.

Schiedel gas flue blocks feature a special rebated jointing arrangement which ensures ease of installation and a positive seal by using the cartridge applied jointing compound. The rebated joint minimises the risk of jointing compound extruding into the flueway.

Available with a comprehensive range of fittings the system gives Architects and Builders an almost limitless choice of economical and efficient solutions for building gas flues.

Approvals and Specifications

The system meets the relevant requirements of Building Regulations and has been successfully tested to BS EN 1858 with the given designation of T250, N2, D, 1, O(50).

Installation and Use

In the UK the system must be installed in line with the recommendations of British Standards BS 5440: Part 1 Covering the installation of flues for gas appliances.

For installation in the Republic of Ireland the flues must be installed and used as the instruction given in this brochure and to the recommendations of IS 813:2002.

The maximum overall height of the flue must not exceed 12 metres and can only be used with gas appliances having a rated input not exceeding 60 kW.

The system can be used with standard gas burning fires and convector heaters in accordance with BS 5871: Part 1. It can also be used with many types of inset live fuel effect gas fire (ILFE's) that imitate solid fuel open fires, providing the appliance manufacturer's instructions allow this and the fire has been approved for use with gas flue blocks.

The flues can be terminated above the roof or at a gas ridge vent terminal, in which case the twin wall gas flue is used from the flue block system in the roof space to a ridge tile adaptor or GO terminal.

The choice of precast recess units provides a low cost answer for accommodating a gas appliance with the flue blocks.

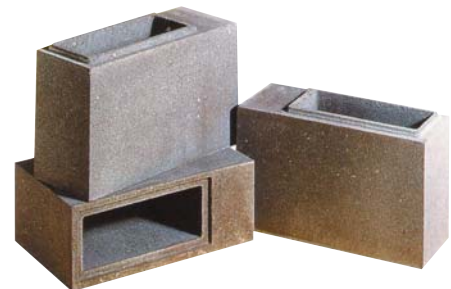

The Schiedel gas flue blocks feature:

- slim space saving design
- positive rebated joints
- comprehensive choice of fittings

A Typical Composition

This illustrates a typical installation using flue blocks built into a wall and connected to a gas ridge vent terminal using components from the Schiedel twin wall gas flue. The notes are intended to give some of the options detailed in the installation instructions.

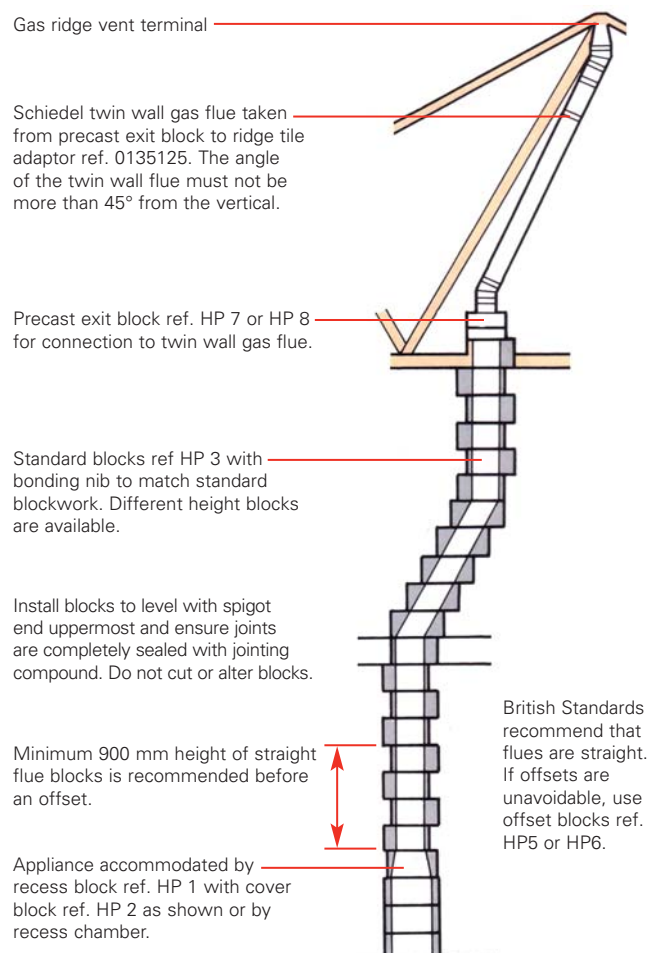

The Standard Range of Components

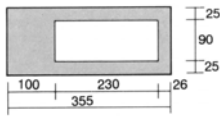

Plan of standard block.
Aspect ratio 1:2.56

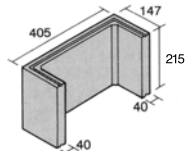

HP1
Recess block. Used to form basic appliance recess.

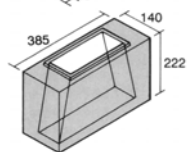

HP2
Cover block. Used to gather in opening above HP1.

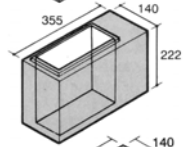

HP3
Standard block 222mm high with nib.

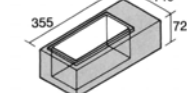

HP3 (72)
72mm high coursing block with nib.

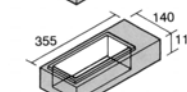

HP3 (112)
112mm high coursing block with nib.

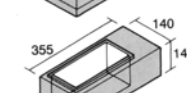

HP3 (147)
147mm high coursing block with nib.

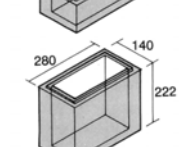

HP4
222mm high block without nib.

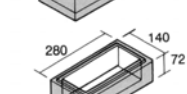

HP4 (72)
72mm high coursing block without nib.

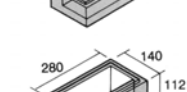

HP4 (112)
112mm high coursing block without nib.

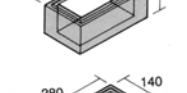

HP4 (147)
147mm high coursing block without nib.

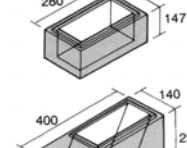

HP5
Side offset block giving 120mm offset.

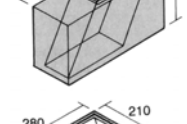

HP6
Back offset block giving 70mm offset.

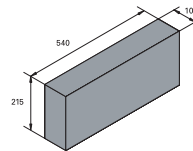

HPDB
High Density Block. Used behind recess units in party walls.

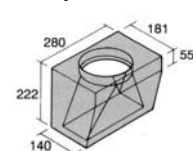

HP7
Vertical exit block for connection to GF twin wall flue.

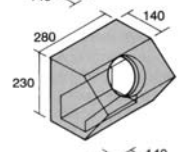

HP8
Angled exit block for connection to GF twin wall flue. Use inverted for connection of boiler flue pipe.

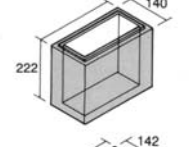

HP9
Reverse rebate block with spigot on both ends. Used with inverted HP7 or HP8.

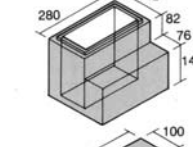

HP10
Corbel block. Used to carry brickwork in front of flue when building a stack above roof line.

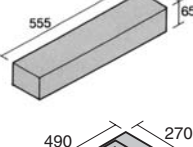

HP11
Lintel block. Used to carry single skin of brick/block work in front of flue to create chimney breast.

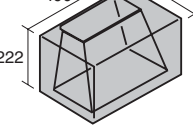

HP42
Deep recess cover block.

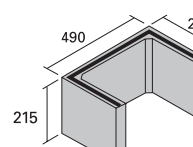

HP41
Deep recess block

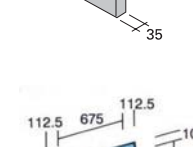

Damp proofing materials

DPCM

DPCM mat with dpc bonded onto insulation. Used in cavity wall behind flue to provide vertical dpc.

Jointing materials

FJC Flue Jointing Compound 300ml cartridge.

Schiedel Gas Flue Block Kits

Steel Ridge Vent Kit

- 2 **1218125** - Adjustable Bend
- 1 **1202125** - Straight Length (900mm)
- 1 **1205125** - Straight Length (450mm)
- 1 **1206125** - Straight Length (300mm)
- 1 **1208125** - Adjustable Length
- 1 **0135125** - Ridge Tile Adaptor
- 2 **0145125** - Connector 125mm ID
- 2 **0173125** - Wall Bands

Steel Straight Kit

- 1 **1202125** - Straight Length (900mm)
- 1 **1208125** - Adjustable Length
- 1 **0145125** - Connector 125mm ID
- 1 **9551125** - Angled Flashing Kit 5° - 30°
- 1 **0130125** - GC1 Gas Vent Terminal

Steel False Chimney Kit

- 2 **1218125** - Adjustable Bend
- 1 **1202125** - Straight Length (900mm)
- 1 **1205125** - Straight Length (450mm)
- 1 **1206125** - Straight Length (300mm)
- 1 **1208125** - Adjustable Length
- 1 **0130125** - GC1 Gas Vent Terminal
- 1 **0145125** - Connector 125mm ID
- 2 **0173125** - Wall Bands

Gas Block Straight Kit with Standard Recess Units

- 3 **HP1** Recess Unit
- 1 **HP2** Cover Block
- 23 **HP3** Standard Block
- 1 **HP8** Angled Exit Block
- 7 **DPCM** Insulated DPCM Mat
- 5 **RAPID** Flue Joint Compound

Gas Block Straight Kit with Deep Recess Units

- 3 **HP41** Deep Recess Unit
- 1 **HP42** Deep Cover Block
- 23 **HP3** Standard Block
- 1 **HP8** Angled Exit Block
- 7 **DPCM** Insulated DPCM Mat
- 5 **RAPID** Flue Joint Compound

Gas Block Bend Kit with Standard Recess Units

- 3 **HP1** Recess Unit
- 1 **HP2** Cover Block
- 13 **HP3** Standard Block
- 10 **HP5** Side Offset Block
- 1 **HP8** Angled Exit Block
- 7 **DPCM** Insulated DPCM Mat
- 5 **RAPID** Flue Joint Compound

Gas Block Bend Kit with Deep Recess Units

- 3 **HP41** Deep Recess Unit
- 1 **HP42** Deep Cover Block
- 13 **HP3** Standard Block
- 10 **HP5** Side Offset Block
- 1 **HP8** Angled Exit Block
- 7 **DPCM** Insulated DPCM Mat
- 5 **RAPID** Flue Joint Compound

The Offset Distance is 720 - 1200mm

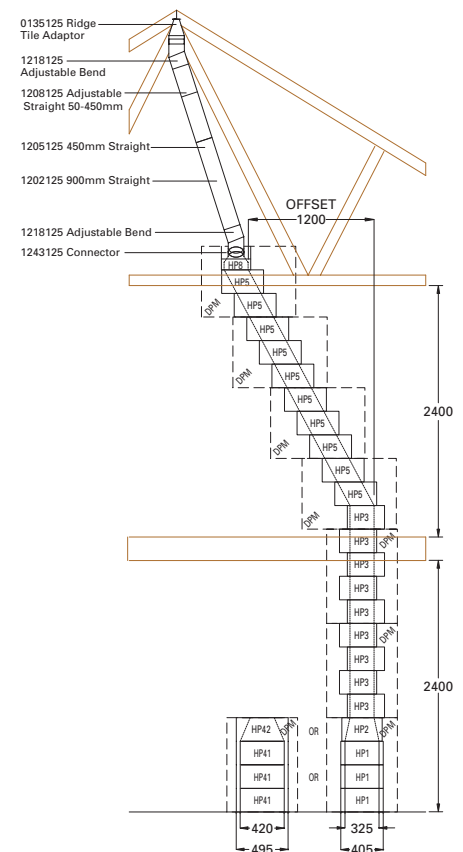
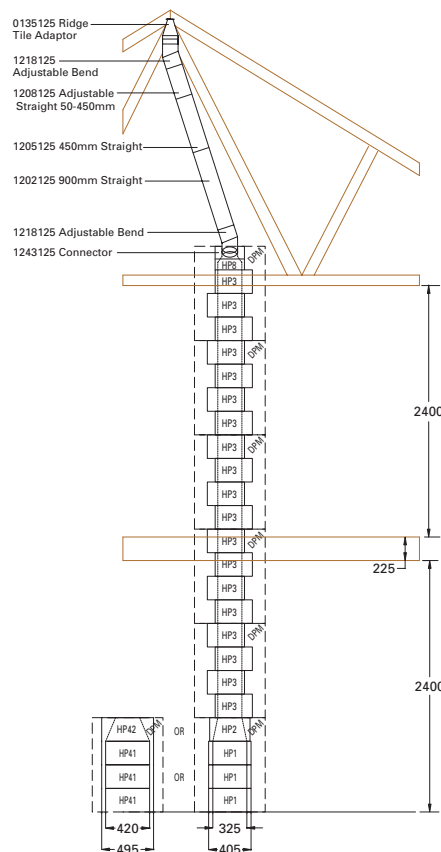

The steel components in these drawings are from Steel Gas Vent Kit 1

The Straight Kit

The Bend Kit

Recess Units

These units offer a choice of recess openings to suit different gas fired appliances, which can be used with the Schiedel gas flue block range.

The recesses will accept most types of standard radiant gas fires which must be installed to BS 5871 : Part 1. Many inset live fuel effect gas fires imitating a solid fuel open fire can also be fitted, but must be approved for this type of application and be installed to BS 5871 : Part 2.

Standard Starter Block Recess

Internal recess opening
675 mm high x 325 mm wide x 115 mm deep.

Consists of

3 no. recess blocks **HP1** and a cover block **HP2** providing a gather above the recess opening with outlet for connection to the HP flue block system.

Units to be laid to level with 10 mm thick mortar joint.

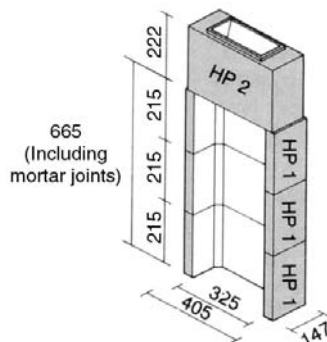

Deep Recess Unit

675 mm high x 420 mm wide x 220 mm deep.

Consists of

HP41 - lower units

Units to be laid to level with 10 mm thick mortar joint.

Connected to the **HP42** cover block.

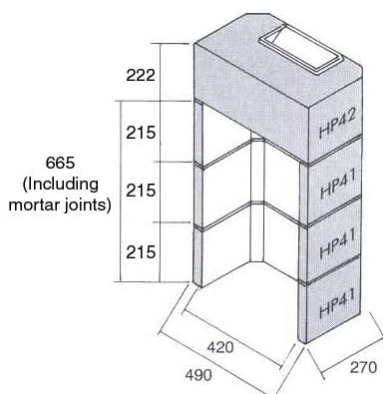

Typical Recess Installations

Standard Recess Arrangement

This is the most popular space saving layout used with a standard radiant gas fire and the HP gas flue block system built into the inner leaf of the cavity wall. A decorative cladding of 100 mm brickwork can be built in front of the flue blocks using a lintel block HP11.

Inset live fuel effect gas fires which imitate an open fire can be fitted in this recess, providing they are approved for use with gas flue blocks. The appliance manufactures installation instructions must be followed and often require fitting of a spacer frame in front of the recess to give sufficient clearance at the back of the appliance.

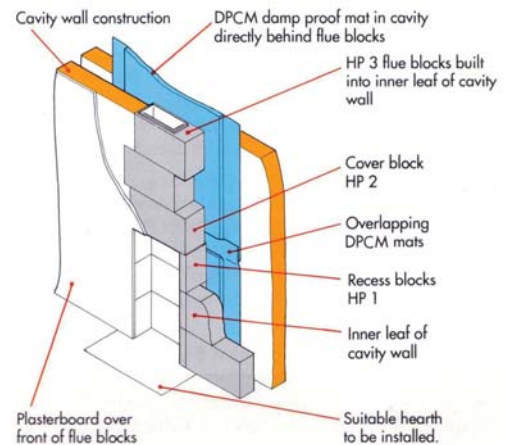

Deep Recess Arrangement

This is commonly used with inset live fuel effect gas fires and is also suitable for use with standard gas fires.

When built into a wall with the Schiedel gas flue block system the projecting recess units can be accommodated by fitting a deep backed surround as shown in the illustration. Alternatively a false chimney breast can be built using plasterboard on stud framework.

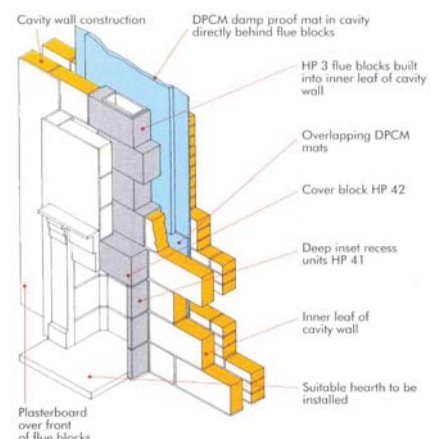

Schiedel Twin Wall Flue

Introduction

The Schiedel Twin Wall Flue is a high quality factory made twin wall gas vent system, with a range of components that simply twist lock together for fast and economical installation. It offers an ideal solution for installing a new flue system for gas appliances and an efficient method for connecting the Schiedel gas flue block system to an external terminal.

Approvals and Specifications

The Twin Wall Flue is approved to BS715 and has been tested and approved to EN 1856-1:2003-06 and carries the designation T250 N1 D VM L11040 050 under certificate 0036 CPD 9195 013.

It is also included in the British Gas list of certified flues and terminals. The product is manufactured under the strict guidance of BSEN ISO 9001.

The flue gas carrying components have a 12.5mm air gap between an aluminium liner (1200 H14) and an aluzink case (ZAZ). The twist locking spigot and sockets are manufactured from aluzink (ZAZ). All vertical seams are lock-formed and the product is manufactured so as to allow thermal expansion of the liner.

Installation and Use

The system must be installed and maintained in accordance with the manufacturer's instructions and in accordance with BS 5440: Part 1 and Doc J of the Building Regulations.

Schiedel Twin Wall Flue is suitable for rated appliances with an input not exceeding 60kW.

Appliances connected to Schiedel Twin Wall Flue must be installed in accordance with the relevant National Standards and applicable Building Regulations.

Method of Assembly

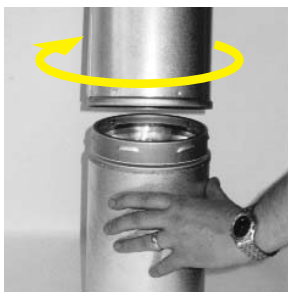

Fig. 1
Twist lock connection

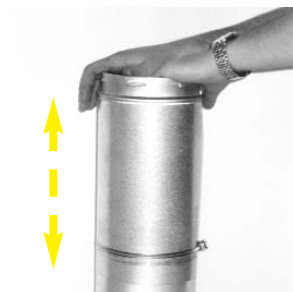
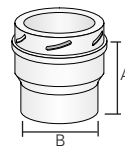

Fig. 2
The height of the adjustable length is achieved as shown.

The Range of Components

Nominal flue diameter - 125mm (5")
Nominal external diameter - 152mm (6")



Flue block adaptor

0145125 - Connector with 125mm spigot for connecting to appliance or exit block.



Adjustable bend (elbow)

1218125 - Adjustable bend giving angle of 0°-90°



Straight lengths

1207125 - Effective length 150mm
1206125 - Effective length 300mm
1205125 - Effective length 450mm
1202125 - Effective length 900mm
1201125 - Effective length 1500mm
1208125 - Adjustable length 50mm to 450mm



Wall band

0173125 - Wall band giving 50mm clearance from wall

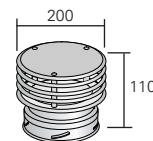

Terminal

0130125 - GC1 gas vent terminal

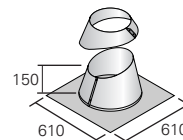

Flashing

95510125 - Angled flashing kit 5° - 45°

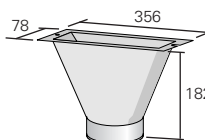

Ridge tile adaptor

0135125 - Fabricated aluminium ridge tile adaptor

Installation Instructions

The Schiedel Gas Flue system can be used as an independent flue to serve gas fired heating appliances requiring a 125 mm flue diameter and also to connect the Schiedel gas flue block system to a suitable termination.

1. Preparation

Any connection of flue components to an appliance not connected to gas can be carried out by a competent person. Connection to an appliance already connected to gas must be carried out by a registered Corgi installer.

2. Location of the flue

The flue can be installed internally or externally but external runs exceeding 3m require a stainless steel insulated flue (Schiedel Rite-Vent K Vent). K-Vent is compatible with the Schiedel twin wall. British Standards recommend that the flue should be installed vertically and that bends should be kept to a minimum. Where bends are used, the angle should not exceed 45° from the vertical.

3. Termination

Ensure that the flue is terminated in accordance with Building Regulations and BS 5440: Part 1. For roof ridge termination use the ridge tile adaptor which must be connected to a suitable gas ridge vent terminal. See details given in gas flue block installation instructions.

4. Clearance to combustible materials

A minimum clearance of 50mm must be kept between the case and any combustible materials.

5. Support and connections

Fit the appliance connector to appliance spigot and seal using fire rope and fire cement or a suitable high temperature silicone.

When connecting to a flue block, use part no. 0145125 and seal appropriately as explained in connecting to appliance. Lateral support should be provided by fitting wall bands at a maximum of 3m intervals.

An adjustable pipe used with a pipe section above the appliance allows easy removal for access to appliance maintenance.

Note: an adjustable must not be fitted above a bend and a wall band must be used above the adjustable as it is not load-bearing. (See Fig. 2 on the opposite page)

6. Jointing the flue components

Pipes, bends, tees and flue gas carrying components are joined together by a simple twist lock bayonet system. The external locking collars should be uppermost and pointing in the direction of the terminal as indicated by the arrow on the product label. (See Fig. 1 on the opposite page)

7. Roof penetration and flashing

Secure the flue with a wall band below the point where it passes through the roof. Seal all joints with silicone to prevent ingress of water.

8. Use and maintenance

Schiedel twin wall is only suitable for gas appliances not exceeding 60kW. Do not use with solid fuel or oil appliances, or appliances that require a larger flue size.

The flue should be cleaned at least annually to ensure that no deposits or condensates accumulate and cause restrictions. Cleaning should be carried out by a registered NACS chimney sweep.

Location of outlet

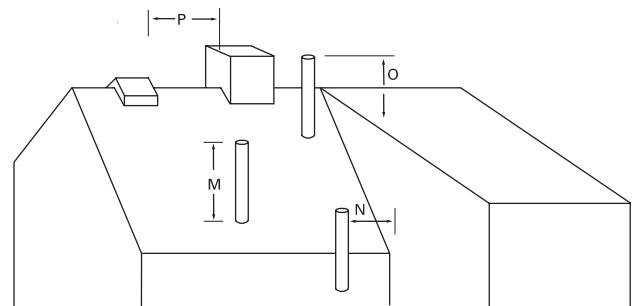

Location of outlet		Application: pressure jet burner	Application: vapourising burner
M	Above the highest point of an intersection with the roof	600mm	1000mm
N	From a vertical structure to the side of the terminal	750mm	2300mm
O	Above a vertical structure which is less than 750mm (pressure jet burner) or 2300mm (vapourising burner) horizontally from the side of the terminal	600mm	1000mm
P	From a ridge terminal to a vertical structure on the roof	1500mm	should not be used

Typical Vertical Internal Flue Arrangement

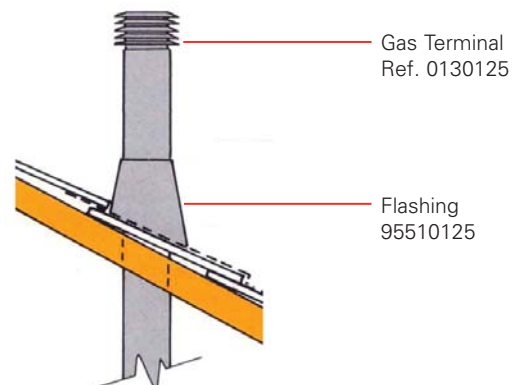

Schiedel Gas Flue Block System

Installation Instructions

Introduction

The product installation and technical details must be followed together with the recommendations of the Building Regulations and British Standards BS 5440.

1. Preparation and handling

Ensure that the correct components have been chosen and are ready for installation to commence.

Store components safely on flat ground and cover to protect against damage and adverse weather conditions. Components that are damaged, altered or cut must not be used.

Safe working access and platforms must be provided in accordance with Health and Safety regulations which must be followed at all times.

2. Location and layout of the flue

As recommended by British Standards the flue should take the most direct practicable route. Inclined (offset) runs should be avoided as a totally vertical flue is preferred. The equivalent flue height for the proposed flue arrangement must be checked in accordance with Appendix A of BS 5440 : Part 1.

Position the flue so that it does not affect or conflict with structural elements such as loadbearing lintels, floor and roof timbers. Combustible material must remain at least 50mm from the outside of the flue blocks. Where the combustible is structural (ie floor joists or roof timbers) this gap should be filled with non-combustible insulation.

Ensure that the joints and courses of the brick/blockwork walls are constructed to a good standard and align with the bonding flue blocks. Terminate the flue at the correct height and location as required by Building Regulations.

3. Appliance installation

Check that the chosen appliance is suitable for the flue arrangement in accordance with the appliance manufacturers installation instructions and recommendations of the relevant part of BS 5871. Installation and connection of the appliance must be carried out by a CORGI registered installer.

The HP system can also be used with many types of inset live fuel effect gas fires that imitate a solid fuel open fire, providing the fire has been tested and approved for use with gas flue block systems. Install the appropriate recess to suit the appliance, some manufacturers specify that a spacer frame is fitted with the appliance to increase the depth of the recess opening.

4. Appliance recess and connection

The flue installation must start with a recess arrangement to suit the appliance or an angled exit block HP8 supported in the wall to suit a boiler type arrangement. A suitable hearth must be provided for the appliance and its depth must be taken into consideration in relation to the finished height of the recess opening.

The following illustrations show typical arrangements with the flue blocks built flush to the front of the inner leaf of the cavity wall. The flue blocks may also be built partially into the wall, in which case the recess arrangement must be positioned as required.

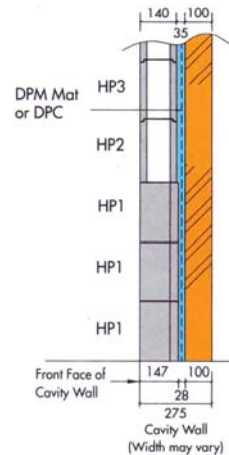

a) Standard recess arrangement

Place the first Recess block HP1 to level into the wall at the required position using standard mortar mix (1 part op cement to 6 parts sand). Lay the next two Recess blocks HP1 and then the Cover block HP2 to level using the same mortar mix.

Ensure the joints are 10 mm thick and align with the coursing joints of the abutting brick/blockwork. Flush point and clean off excess mortar from the joints, which must be completely made to provide a gas tight seal.

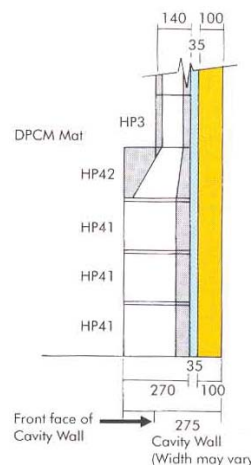

b) Deep recess arrangement

Place the first recess block HP 41 to level into the wall at the required position using standard mortar mix (1 part op cement to 6 parts sand). Lay the next two recess blocks HP 41 and then Cover block HP 42 to level using the same mortar mix.

Ensure the joints are 10 mm thick and align with the coursing joints of the abutting brick/blockwork. Flush point and clean off excess mortar from the joints, which must be completely made to provide a gas tight seal.

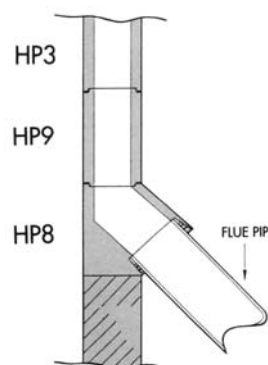

c) Boiler flue pipe connection

Lay the Angled exit block HP 8 into the wall using standard mortar at the required height to suit the proposed boiler. Then lay a Reverse rebate block HP 9 above using the jointing method described in instruction 5. The flue pipe must be sealed into the exit block using fire cement and non-combustible rope.

5. Jointing the flue blocks

ALL THE FLUE BLOCKS MUST BE LAID SPIGOT END UP WITH A 3mm THICK JOINT THAT IS COMPLETE AND GAS TIGHT.

The most convenient method of jointing is to use cartridges of ready mixed high temperature mortar applied with a cartridge gun. The nozzle must be used and cut 35 mm from the end to give a 8mm bead. Ensure the upper face of the block is dry and clear of debris.

Apply a continuous 8 mm thick bead of the compound onto the upper face of the block against the shoulder of the spigot. Do not allow any compound to go onto the top of the spigot.

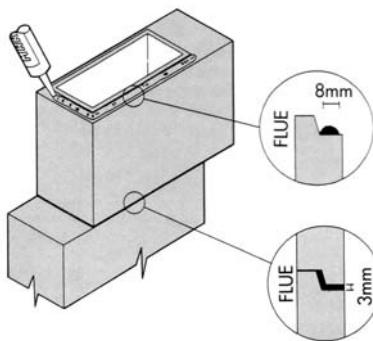

Bed the next block with the socket end facing down into the jointing compound and make a complete seal with a 3mm thick joint. Flush point the joint on the outside of the blocks and remove any excess mortar in the flue way.

6. Protecting the flue on site

It is good practice at the end of each day or during heavy rain to cover laid flue blocks to prevent joints being washed out.

7. Installing the flue blocks

Blocks with bonding nibs must be built into the surrounding masonry and laid with the nib on alternative sides as each course is built. Bonding the flue blocks into the wall should start as soon as is practical above the recess or appliance connection arrangement. The joints in the surrounding masonry must align with the joints of the flue blocks.

If adjustment in the coursing of the flue blocks is required use the appropriate HP coursing blocks. Do not alter or cut any flue blocks to make on-site adjustments.

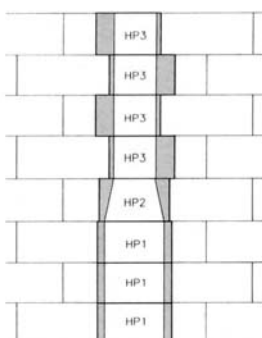

8. Offsets

Both British Standards and British Gas recommend that vertical flues are preferred. Offsets if unavoidable should be kept to a minimum using the appropriate offset blocks installed and jointed in the same way as the standard flue blocks. A minimum 900mm height of straight blocks is recommended before an offset in the flue.

Typical side offset arrangement

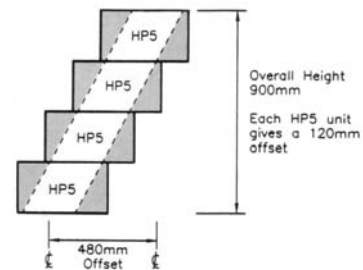

Typical back offset arrangement

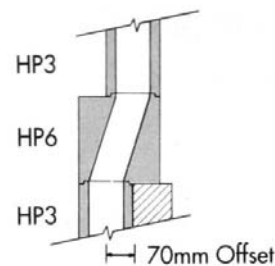

9. Building the flue blocks into a wall

The flue blocks can be built flush or partially into solid or cavity wall construction. The following illustrations show the construction requirements.

a) Installation into external cavity wall.

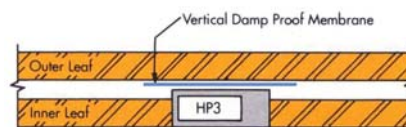

If the external wall is in an exposed position or the flue blocks project into or reduce the cavity, a vertical damp proof membrane must be installed in the cavity behind the flue blocks as per instruction 10.

The provision of a vertical dpm is not required if the full depth of the cavity is maintained i.e. where the flue is built into an inner leaf of the same or greater thickness as the flue blocks.

Schiedel Gas Flue Block System

b) Installation into party wall

When recess units and flue blocks are built into a party wall compliance with Document E of the Building Regulations can be satisfied by the installation being carried out in accordance with the Robust Details. You will need to install the high-density blocks behind the recess units, an 8mm render coat with scratch finish and 12.5mm of plasterboard to both faces of the wall.

Please see diagrams 1 and 2.

1) Plan of Recess Units

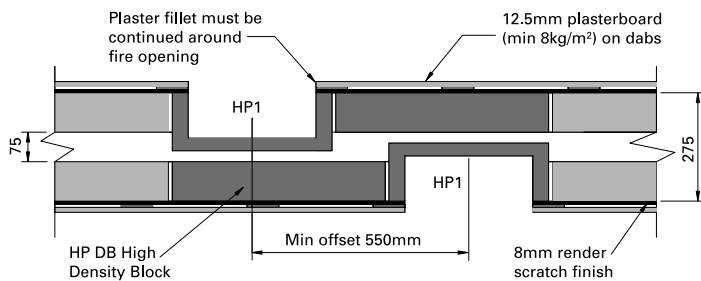

2) Plan above Recess Units

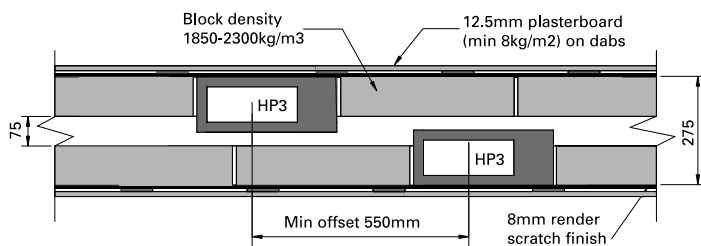

10. Vertical damp proof course in external cavity wall construction

When the flue blocks project into or reduce the cavity in an external cavity wall construction the installation of a vertical damp proof membrane in the cavity behind the flue blocks is required.

The most convenient method is to use the DPCM mats. These must be placed with the damp proof membrane (DPM) against the external leaf of the cavity wall, ensuring the DPM oversails all edges of the flue blocks by at least 50 mm and is secured against the external leaf.

The bottom flange of the DPM on the first mat must be dressed down against the external leaf of the cavity wall. When placing the mats on top of each other ensure they abut tightly without any gaps.

Ensure that the DPM and cavity trays provide complete protection for the full length of the flue block arrangement and are not torn or punctured. If necessary suitable wall ties can be used to secure the mats in place.

Typical installation of DPCM mats

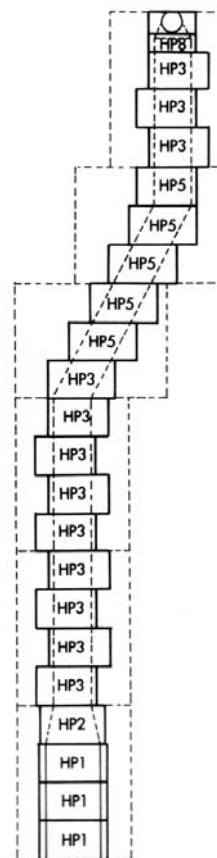

To prevent water penetration into the building a suitable cavity tray must be installed directly above the top mat and any other horizontal surfaces of the mat which are exposed on their upper edge. The cavity wall tray must project at least 100 mm beyond the edge of the mat and incorporate stop ends. The DPM flange at the top of the mat must be secured up against the inner leaf directly below the cavity tray.

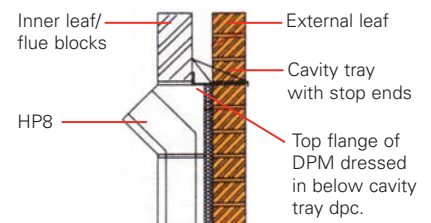

At all horizontal joints the DPM flange at the top of the lower mat must be dressed up against the inner leaf of the cavity wall with the bottom flange of the upper mat totally overlapping the top of the lower mat against the face of the external leaf of the cavity wall.

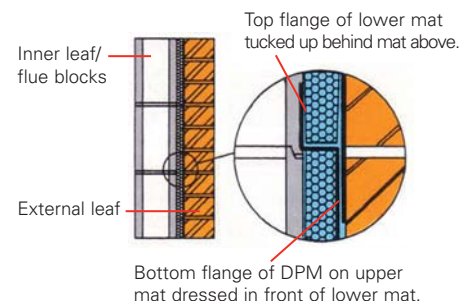

11. Termination

The gas flue block system can be terminated as follows:

a) Ridge vent arrangement

Finish the flue blocks in the roof space with an HP 7 or HP 8 exit block. Convert to the twin wall flue by sealing the connector 1243125 into the exit block with fire cement and non-combustible rope. Extend the twin wall flue to a ridge tile adaptor 0135125 and connect to an approved gas ridge vent terminal.

Typical detail of termination at Gas Ridge Vent Terminal

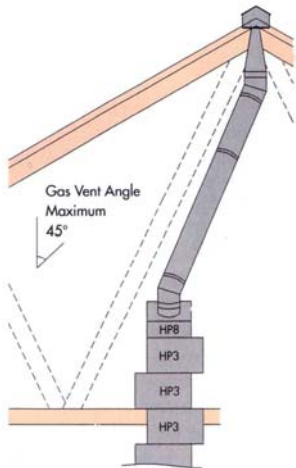

The twin wall flue pipe must be supported and installed at an angle not more than 45° from the vertical into the ridge tile adaptor 0135125 to which an approved gas ridge vent terminal must be fitted.

b) Chimney stack arrangement

If a traditional chimney stack is required the Corbel block HP10 and a suitable prestressed lintel can be used just below the roof line to support 100 mm thick masonry in front of the flue blocks. The masonry on the remaining three sides is to be supported on the surrounding walls. The flue is continued using HP 4 flue blocks and is finished with a Vertical exit block HP 7 onto which an approved Gas terminal is to be sealed with mortar flashing.

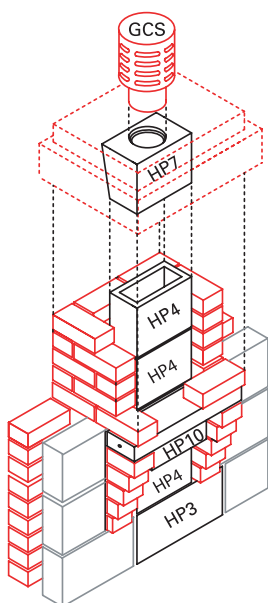

The flue arrangement must be finished off with a concrete capping or corbelled brickwork and mortar flashing with a dpc to prevent water penetration.

Standard flashings and dpc's must also be provided at the point where the flue and masonry cladding passes through the roof.

The flue must terminate at the correct height in accordance with Building Regulations shown in the installation details.

c) Using Schiedel twin wall gas flue

The twin wall gas flue can be used from the exit block connection to take the flue through the roof. Refer to the Schiedel installation instructions and minimum termination heights.

12. Internal finishes

The flue blocks directly above the appliance should not be plastered as unsightly surface cracking may occur whilst using the appliance. It is recommended that a plasterboard facing is placed in front of the flue blocks with a small air gap in between. This can be achieved using stud work or plaster board on dabs which must not be placed on the front of the flue blocks.

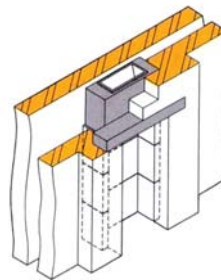

Alternatively masonry cladding can be built in front of the flue blocks to create a chimney breast feature. The Lintel block HP 11 can be used directly in front of the Cover block HP 2 of the standard recess arrangement.

Any gaps between the plasterboard or masonry facing and recess arrangement must be completely sealed around the recess opening. At first floor level and above plaster or render finishes can be applied onto the flue blocks.

13. Checking and testing the flue

British Standards require that all flues are checked and smoke tested during construction to ensure the flue components and particularly all joints are installed correctly.

The flue block installation should be smoke tested at each floor level during construction and once the last block has been fitted (ie. an exit block). A further smoke test should be made once the terminal is fitted and include testing of any twin wall flue if used as part of the flue arrangement.

a) Smoke test procedure

The following is based on the method described in BS 5440 Part 1 : 2000.

- Pre-heat the flue for 2 to 5 minutes using a blow torch. With very wet or cold flues a longer warming up time may be needed to establish a draw in the flue.
- Place a flue testing smoke pellet on a brick or similar in the opening at the base of the flue.
- Ignite the pellet and when it starts smoking place a board or plate over the opening leaving a gap of 25 mm at the bottom to allow air to enter the flue.
- Check that the smoke is exiting freely from the correct terminal and examine the full length of the flue for any leakage of smoke.
- If possible check wall cavities at the back of the flue or openings around the windows.
- If smoke is seen investigate to identify the point of leakage and carry out remedial work to correct.
- After completing the remedial work repeat the testing procedure until no leakage is apparent.
- Follow the smoke pellet manufacturers safety instructions.

b) Appliance spillage test

Once the appliance is fitted a CORGI registered installer or similar qualified person must carry out a spillage test in accordance with the appliance manufacturers instructions and British Standard recommendations.

The full range of Schiedel products

Click on www.schiedel.co.uk or www.schiedel.ie for a full range of chimney systems and accessories available from Schiedel.

Schiedel Chimney Systems

- The Schiedel Swift chimney system combines speed and ease of assembly with consistent quality.
- Suitable for Timber Frame, Steel Frame and Masonry construction.
- Modular units for easy assembly on site. An 8 metre internal chimney can be constructed from ground floor to chimney pot in 5 hours.
- Suitable for all fuels - gas, oil, wood and solid fuels.
- Everything you need. All the components required to construct the chimney from the ground floor to the chimney pot are supplied on one or two pallets.



Ceramic and Concrete Products

- Schiedel Chimney Systems has a competitive range of clay flue liners, chimney pots and ridge tiles.
- Schiedel is the only company in the UK and Ireland to have the CE Mark on its flue liners.
- Also available are the Gas Flue Block system and a range of concrete liners.



Pumice Systems

- The Schiedel ISOKERN chimney systems provide a lightweight, easily installed and versatile chimney which can be used internally or externally.
- The systems are suitable for use with gas, oil, solid fuel and wood burning appliances in new and refurbished projects.
- They are ideal for Timber Frame and Steel Frame construction.
- ISOKERN chimneys have been installed in Europe for over 60 years.

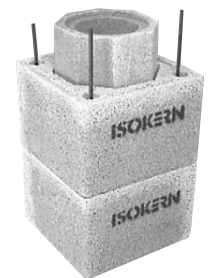

SCHIEDEL
ISOKERN®

Steel Chimneys

- Schiedel Chimney Systems has a comprehensive range of steel flues to meet a wide range of applications.
- The range includes twin wall, single wall and flexible steel flues for use with oil, gas and solid fuels.



SCHIEDEL
RITE-VENT

Washingbay Road
Coalisland, Co. Tyrone
BT71 4ND
Tel: 028 8774 0436
Fax: 028 8774 7430
office@schiedel.co.uk
www.schiedel.co.uk

Carrickmacross
Co. Monaghan,
Ireland
Tel: 042 9661766
Fax: 042 9662494
office@schiedel.ie
www.schiedel.ie

Shawell Plant, Gibbet Lane
Shawell, Lutterworth,
Leicestershire LE17 6AB
Tel: 01788 860930
Fax: 01788 536151
shawell@schiedel.co.uk
www.schiedel.co.uk

14 Haviland Road
Ferndown Industrial Estate.
Wimborne, Dorset BH21 7RF
Tel: 01202 861650
Fax: 01202 861632
sales@isokern.co.uk